

- Area of Development with stripmine restrictions
- Area of Development with deepmine restrictions
- Area of Development with no soil restrictions
- Area of No Structures over deepmines below Elevation 1070

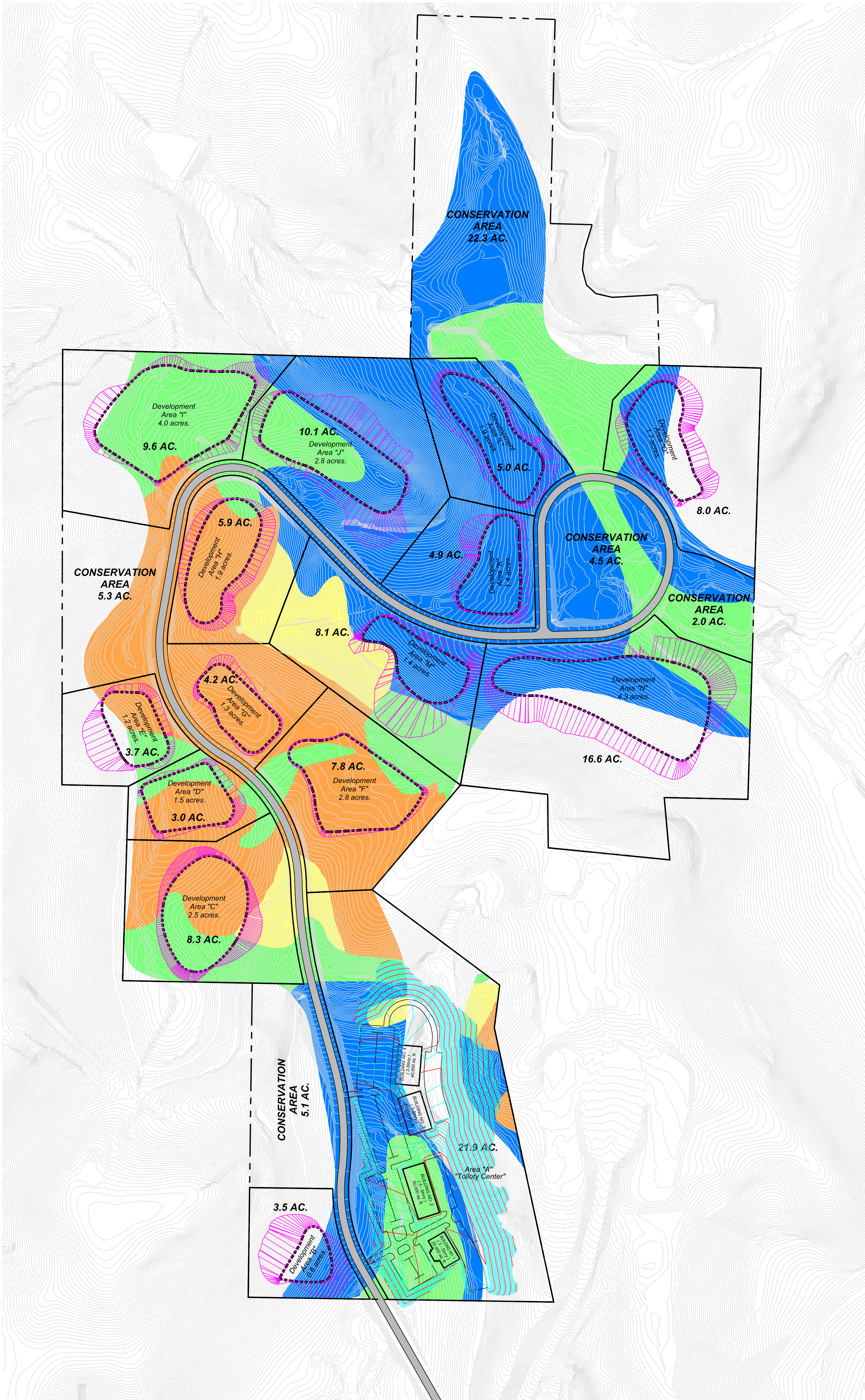

**Tuscarawas Regional Technology Park
Preliminary Site Development Data**

Development Area	Site Area	Estimated Pad Area	Potential Building Area	Pad Excavation	Estimated Cost	Grading Cost per s.f.
A	21.9 ac.	6.8 ac.	155,000 s.f.	157,212 c.y.	\$550,242.00	\$3.55
B	3.5 ac.	0.6 ac.	9,504 s.f.	13,208 c.y.	\$46,228.00	\$4.86
C	8.3 ac.	2.5 ac.	39,600 s.f.	22,080 c.y.	\$77,280.00	\$1.95
D	3.0 ac.	1.0 ac.	23,760 s.f.	10,334 c.y.	\$38,169.00	\$1.52
E	3.7 ac.	1.2 ac.	19,008 s.f.	14,386 c.y.	\$50,351.00	\$2.65
F	7.8 ac.	2.8 ac.	44,352 s.f.	6,727 c.y.	\$23,544.50	\$0.53
G	4.2 ac.	1.3 ac.	20,592 s.f.	5,411 c.y.	\$18,938.50	\$0.92
H	5.9 ac.	1.9 ac.	30,096 s.f.	17,390 c.y.	\$60,550.00	\$2.01
I	9.6 ac.	4.0 ac.	63,360 s.f.	27,598 c.y.	\$96,593.00	\$1.52
J	10.1 ac.	2.8 ac.	44,352 s.f.	26,423 c.y.	\$92,480.50	\$2.09
K	4.9 ac.	1.4 ac.	22,176 s.f.	10,920 c.y.	\$38,220.00	\$1.72
L	5.0 ac.	1.9 ac.	30,096 s.f.	17,788 c.y.	\$62,251.00	\$2.07
M	8.1 ac.	1.4 ac.	22,176 s.f.	16,180 c.y.	\$56,630.00	\$2.55
N	16.6 ac.	4.3 ac.	68,112 s.f.	88,166 c.y.	\$308,581.00	\$4.53
O	8.0 ac.	1.7 ac.	26,928 s.f.	19,200 c.y.	\$67,200.00	\$2.50
Estimated Totals	120.6 ac.	36.1 ac.	619,112 s.f.	452,931 c.y.	\$1,585,258.50	\$2.56



CONCEPTUAL DEVELOPMENT PLAN

LOCATION:
THE CITY OF NEW PHILADELPHIA, TUSCARAWAS COUNTY, OHIO

SCALE: 1" = 200'
 SURVEYED:
 DRAWN: S.J.L. 10-12-09
 CHECKED:
 DATE: 11-18-09

THE TUSCARAWAS REGIONAL TECHNOLOGY PARK

DIVERSIFIED ENGINEERING INC.
 225 Fair Avenue, NE
 New Philadelphia, Ohio
 330-364-1631

FILE ID: ENG-712

SHEET 1 OF 1